



NAVNAUTIK

LIST OF OFFSHORE / CRANE / ACCOMMODATION BARGES DESIGNED BY NAVNAUTIK PTE LTD, SINGAPORE

Vessel Type	Yard	Client	Vessel specs
1. 250 Men Accommodation Barge	Fujian Mawei Shipbuilding, China	PT Rig Tenders Indonesia	90m x 30m x 6.1m Hotel-standard accommodation for 250 men Equipped with pedestal crane and Helideck
2. 180 Men Offshore Support / Crane Barge	PT Samudra Marine, Indonesia	PT Rig Tenders Indonesia	95.4m x 30m x 6.5m Hotel-standard accommodation for 180 men Equipped with pedestal crane and Helideck
3. 275 Men DP2 Accommodation Barge	SHOFT ENGINEERS PVT. LTD, MUMBAI	DOLPHIN OFFSHORE ENTERPRISES (MAURITIUS)	90m x 30m x 6.1m Hotel-standard accommodation for 50 men Equipped with crawler crane and Helideck
4. 300 Men Offshore Support / Crane Barge	POET, China	Pacific Workboat, Singapore	95.4m x 30m x 6.5m Hotel-standard accommodation for 180 men Equipped with pedestal crane and Helideck

1. 250 Men Accommodation Barge – 'DUTA 7'



2. 180 Men Offshore Support / Crane Barge

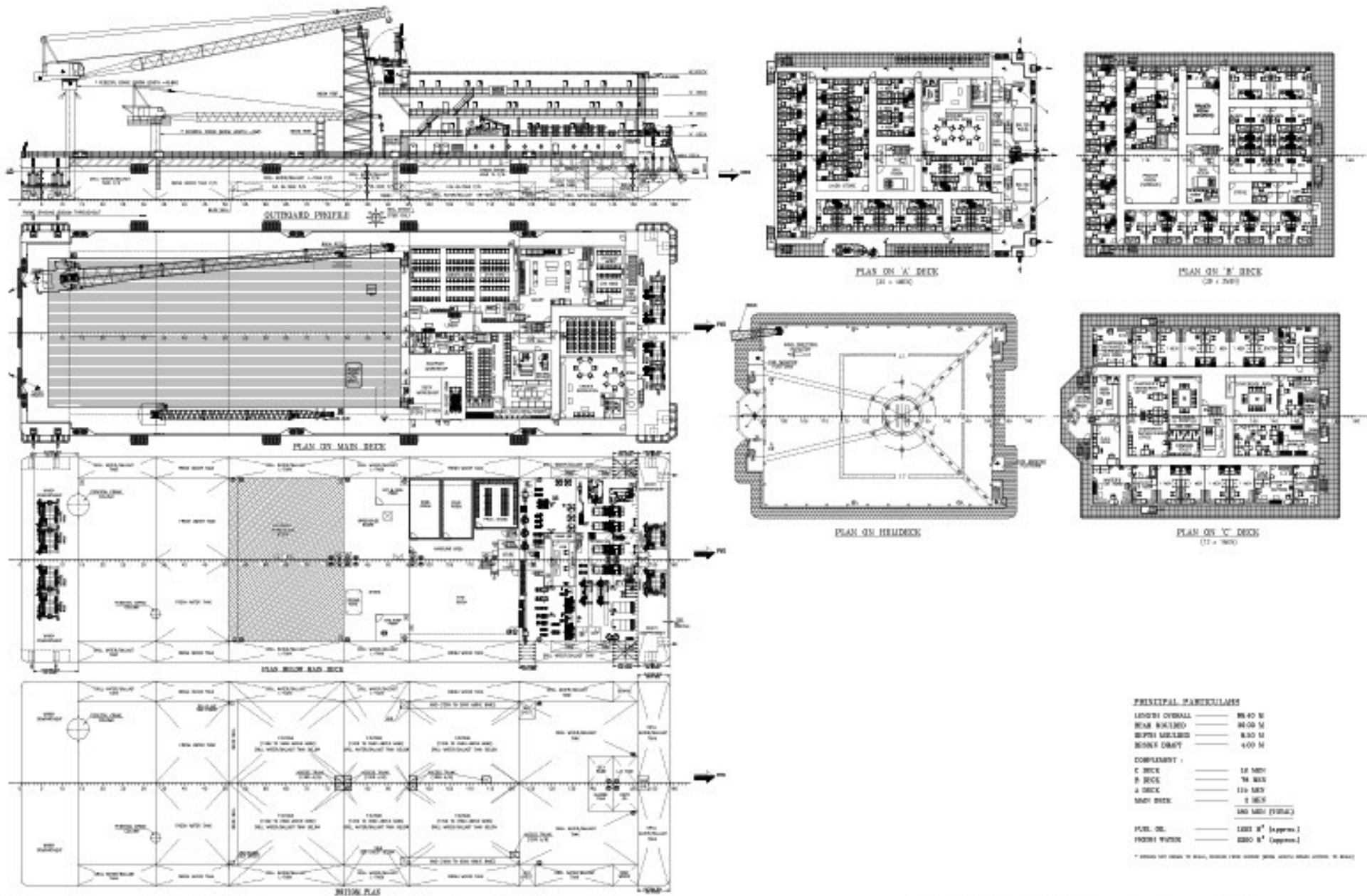

REV	DESCRIPTION OF ALTERATION	DATE	BY

DESIGN NO.	180	SCALE	1:100	PROJECT	180 MEN OFFSHORE SUPPORT / CRANE BARGE	DESIGNER	CONSTRUCTION MTE LTD
CHECKED		DATE		BY	GENERAL ARRANGEMENT		180 MEN OFFSHORE SUPPORT / CRANE BARGE
APPROVED BY CLIENT		DATE		BY	180 MEN OFFSHORE SUPPORT / CRANE BARGE		180 MEN OFFSHORE SUPPORT / CRANE BARGE
APPROVED BY OWNER		DATE		BY	180 MEN OFFSHORE SUPPORT / CRANE BARGE		180 MEN OFFSHORE SUPPORT / CRANE BARGE

3. 275 Men DP2 Accommodation Barge – ‘VIKRANT DOLPHIN’

DOLPHIN OFFSHORE ENTERPRISES MAURITIUS (PVT.) LIMITED.

(Rogers House, 5 President John Kennedy Street Port Louis, Mauritius)
(275 MEN DP2 ACCOMODATION BARGE)



Builder Class Class Notation Flag Official No. Call Sign Year of Built	Shoft Engineering Works Pvt. Ltd ABS ABS+1 Accomodation Barge DP2 Compliance with SPS Code 2008 Mauritius MR 287 3BRS October'11	DECK EQUIPMENTS Mooring Anchors Mooring Equipment Mooring Winch Mooring wire Winch Drum Towing Equipment	Eight units "Flipper Delta" type anchors minimum 6900 Kg. 8 point Mooring system. 8 no. SEKWANG SKH-MW-45T 45T @0-7.5M/MIN at rated Load 20T@0-15M/MIN at rated Load Brake Holding Capacity-80T. 2 nos Electro-Hydraulic Power pack . Local and Remote Control,Auto spooling system,payout indicator and Tension control with preset audio and visual alarm.CCTV for each Mooring drum with display at remote. Six, 1200 m in length and 40mm in dia of galvanized Steel mooring wire.2 nos 1200m ,50 mm dia. Also for anchor. Suitable for 1200 m of 40 mm dia. wire rope, and fitted with band brakes of robust design. C/w towing Bracket and Panama chocks.
DIMENSION Length overall Breadth MLD. Depth MLD Design Draft GRT NRT Deadweight Deck Load Clear Deck Area Helideck	90.00 m 30 m 6.1m 3.4 m 7740 2322 6000 MT 10t / m. sq. 1200 m. sq.covered with wooden deck sheating Suitable for Sikorsky S61N		
MACHINERY Main DG set Emergency generator Service Air Compressor Sewage Treatment Plant Oily water separator Incinerator Garbage Compactor	3 x 500 KVA Cummins KTA19-D(M1) 1 x 500 KVA Cummins KTA19-D(M1) 2 no.ELGI E-75-8 750m ³ /hr@7bar. 2 x 150 person capacity Make-Hamworthy 2.5m ³ /hr ,with 15ppm alarm 200L/hr	FIRE FIGHTING Fire detection system Major Fire Fighting Equipments	Combustible Gas Detection System in accomodation Fire Detection & Alarm System in accomodation and pump/genset room with manually operated call points. Emergency Shut Down System GS/Fire pump(150cu.m/hr x 90M Head), Emergency Fire Pumps(160 cu m/hr x 90 m head) Water sprinkler system for complete accomodation. Fire-Fighting System with CO2. Heli-deck Fire-Fighting System with Foam. Water Mist system for Main Generators.

4. 300 Men Offshore Support / Crane Barge – 'P.W. NATUNA'

